

**PREINSTALLATION
VORINSTALLATION**

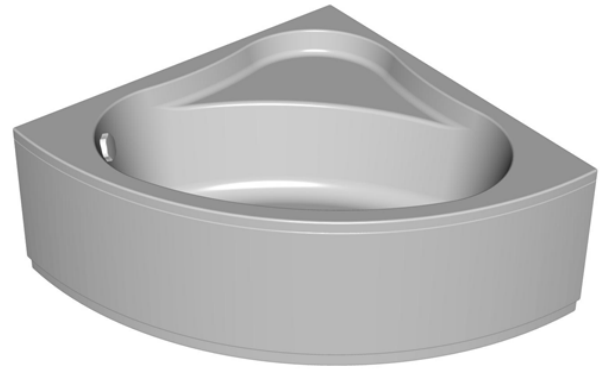
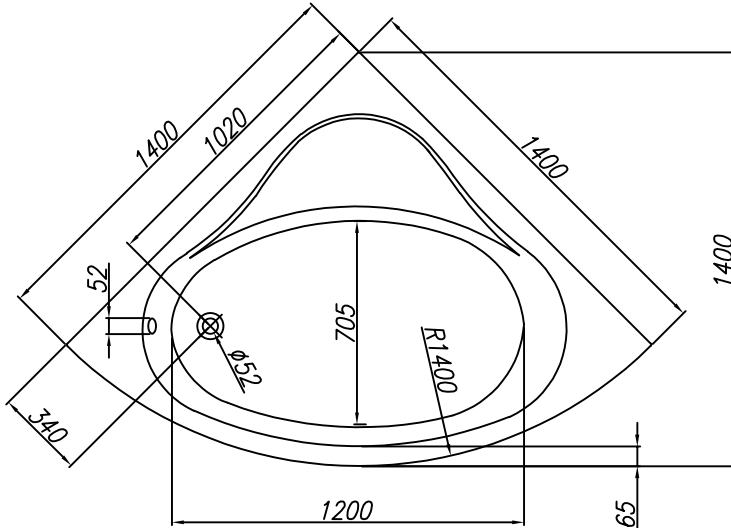
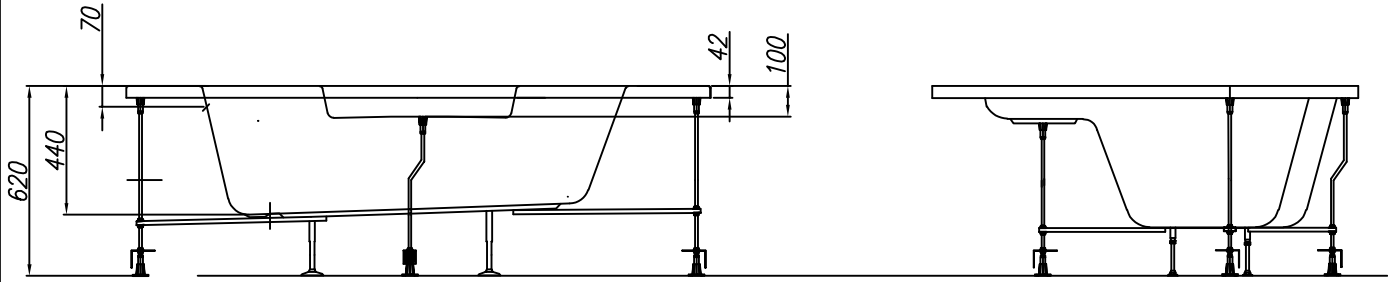

| VOLUME (l) | MAX. LOAD (kg) | FLOOR LOAD (kg/m ²) |
|-------------|---------------------|-------------------------------------|
| VOLUMEN (l) | MAX. BELASTUNG (kg) | BODENBELASTUNG (kg/m ²) |

240

390

260

- Spot for el. cable 3x2.5mm², length approx. 1m
- Platz Stromkabel 3 x 2,5 mm², Länge cca. 1 m
- Spot for el. cable 1x6mm² for earthing, length approx. 1.5m
- Platz Stromkabel 1 x 6 mm² für Erdung, Länge cca. 1,5 m





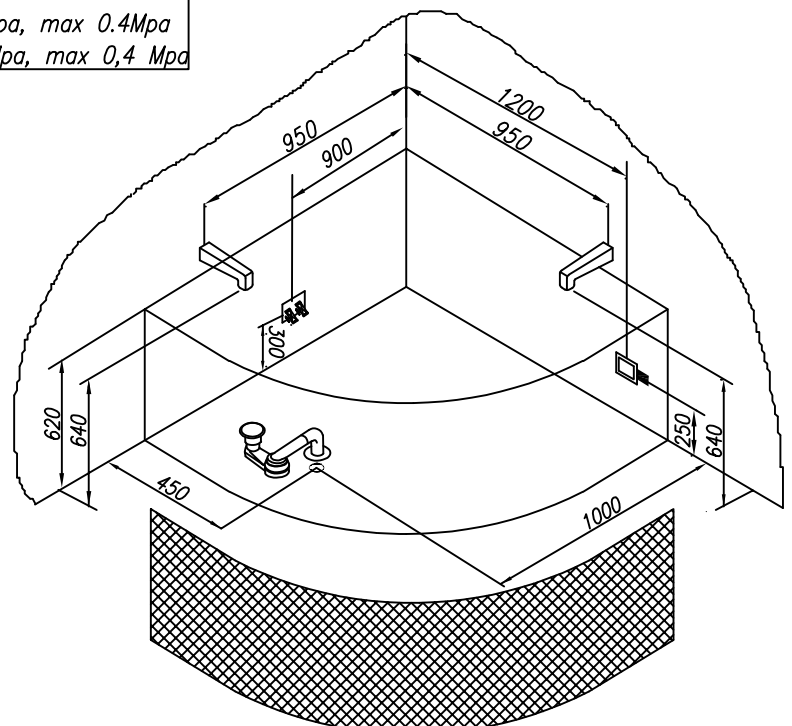

- Connection of hot and cold water 1/2" min 0.2Mpa, max 0.4Mpa
- Anschluss Warm- und Kaltwasser 1/2" min 0,2 Mpa, max 0,4 Mpa

- Drain spot Ø 50mm
- Abflussplatz Ø 50 mm
- Panel - option
- Möglichkeit - Schürze

**INSTALLATION RECOMMENDATION
MONTAGEEMPFEHLUNG**

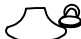
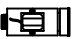
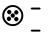
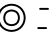
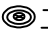

| | |
|---|---------------------|
| Recommended overflow set Vorgeschlagene Überlaufgarnitur | PAL 450 |
| Recommendations for the installation of bathtub without panel Empfehlungen für die Montage von Badewannen ohne Schürze | Nr. MK 02 |
| Recommendations for the installation of bathtub with panel Empfehlungen für die Montage von Badewannen mit Schürze | Nr. MK 01 |
| Option of the built-in bathtub base Möglichkeit des Sockels für die Badewannen ohne Schürze | Nr. MK 07 1001/L |
| Option of the bathtub base with panel Möglichkeit des Sockels für die Badewannen mit Schürze | Nr. MK 21 CD 140 |

-  - PUMP
- WASSERPUMPE
-  - WATER JETS
- WASSERDÜSEN
-  - AIR CONTROLLER
- LUFTREGLER
-  - ELECTRONIC SWITCHES
- ELEKTROSCHALTER
-  - FIXTURE AND SHOWER HANDLE
- WASSERHAHN UND DUSCHE
-  - BLOWER
- LUFTPUMPE
-  - AIR JET
- LUFTDÜSE
-  - PNEUMATIC SWITCH
- PNEUMATIKSCHALTER
-  - LIGHT OR CHROMOTHERAPY
- LICHT- ODER CHROMOTHERAPIE
-  - MICROJET SWITCH
- SCHALTER FÜR MIKRODÜSEN

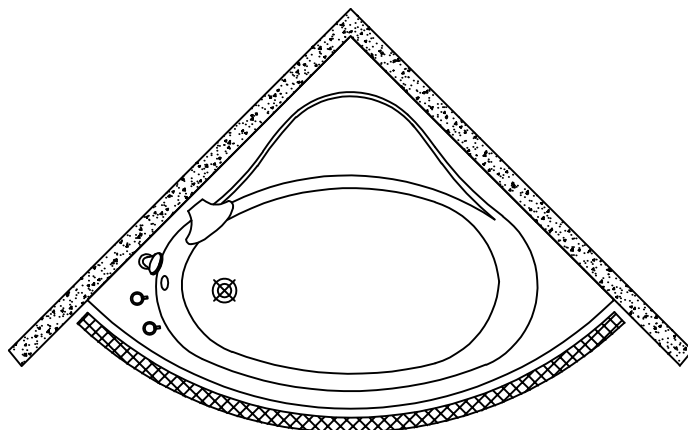
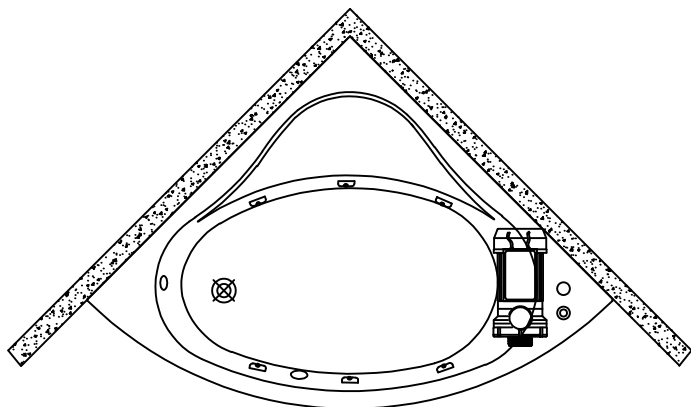

WATER MASSAGE SYSTEM 1 WASSERMASSAGESYSTEM 1

- PUMP P=800W
- PNEUMATIC SWITCH
- AIR CONTROLLER
- 6 WATER JETS
- WASSERPUMPE P = 800 W
- PNEUMATIKSCHALTER
- LUFTREGLER
- 6 WASSERDÜSEN

- OPTION FIXTURE AND SHOWER HANDLE - MÖGLICHKEIT WASSERHAHN UND DUSCHE

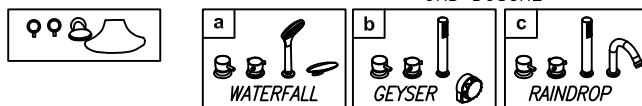

- OPTION PANEL FOR BATHTUB - OPTION SHÜRZE FÜR BADEWANNE

